

MES technology with 3Tec

Kitchen Worktop Fabrication

- ▶ Up to 900 customer-specific worktops per shift
- ▶ Processing centers edgebanders by **IMA Klessmann**
- ▶ Storage, process and logistics by **SYSTRAPLAN**
- ▶ Size of finished parts: 400 x 300 up to 5500 x 1200 mm
- ▶ Size of reusable boards: 1300 x 600 up to 5500 x 1200 mm

- 01 Preparation of stacks
- 02 Rack storage for single boards and stacks
- 03 Infeed for 2 saw lines
- 04 Crosscut saw
- 05 Crosscut saw with trim attachment
- 06 Label printer
- 07 Return of reusable boards
- 08 Trim cut saw
- 09 Edgebander for blind edging
- 10 Buffer area for processing centers
- 11 Processing centers
- 12 Manual quality control
- 13 Buffer for edgebanding
- 14 Automatic edgebander for up to 4 passes
- 15 Manual infeed and outfeed of worktops
- 16 Quality control
- 17 Packing line
- 18 Manual processing
- 19 Manual edgebander with automatic data preparation
- 20 Sorting on trolleys with scanning (delivery-based)

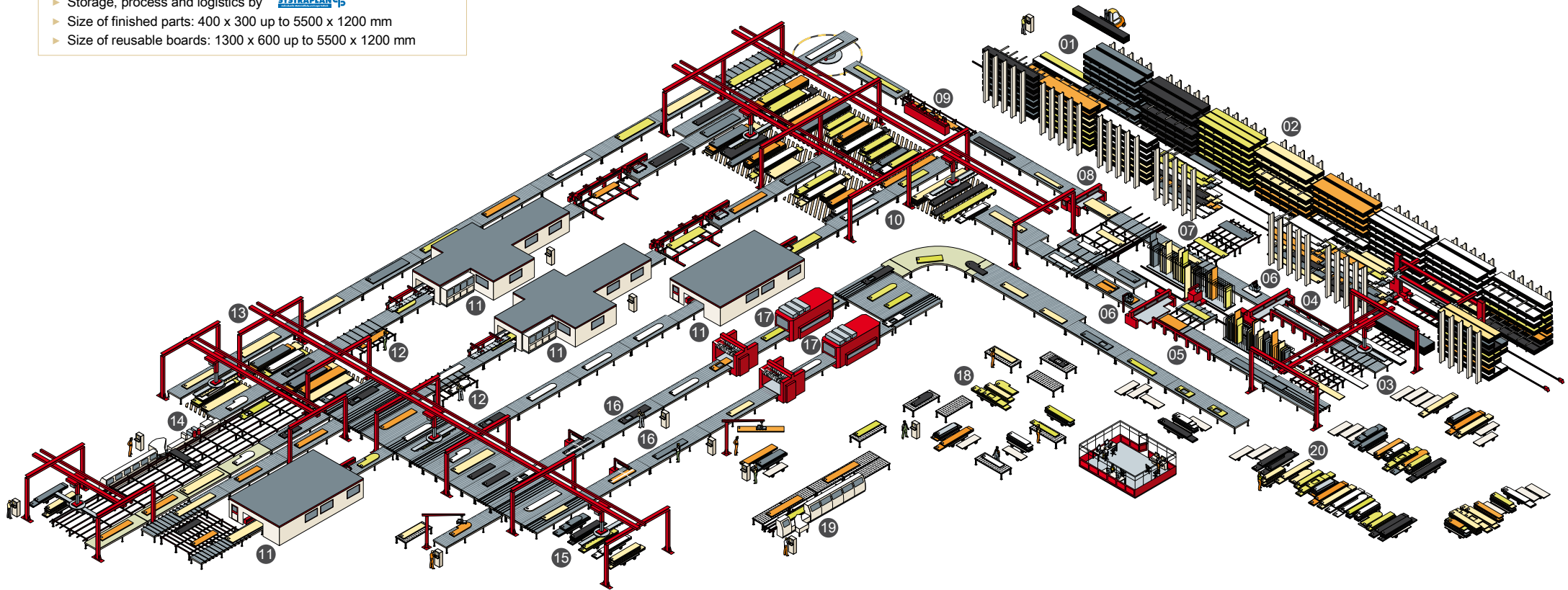

Automation | Information | Transparency

3Tec automation GmbH & Co. KG
 Wilhelmstraße 8
 D-32602 Vlotho
 fon+49.(0)57 33.87 12-0
 fax+49.(0)57 33.96 00 07
 info@3tec.de
 www.3tec.de

3TEC

MES technology with 3Tec

Kitchen Worktop Fabrication

- **Automatic high-bay rack storage for raw and reusable boards, singles or stacks**
- **Crosscut and trim cut**
- **Labelling of component parts**
- **Intermediate buffer for processing centers and edgebanders for building batches (Quick shots for current and next production cycle)**
- **Possible automatic destination change in case of machine failure**

Production data import and preparation

- All data relevant to production is imported from the ERP system
- Production data stored in MS-SQL database
- Planning and cutting plan optimization
- Data preparation for edgebanders and processing centers
- Edgebander preview and edge material administration
- Handling of re-productions and quick shots

Control system

Warehouse management and control

- Automatic high-bay rack storage (fast raw board infeed via stacks, pre-commissioning, and reusable board handling)

Material flow control

- Tracking of individual parts
- Buffer management
- Connections to production machines
- Labelling
- Monitoring via barcode scanning

System-wide display elements

- Quality control after processing centers and packing
- Operator guidance
- Diagnostics and error recovery